

- Decorative radiators ■ Comfortable indoor ventilation
- Heating and cooling ceilings ■ Industrial air cleaning

Zehnder EVO 2

zehnder

EN

EN Quick Guide



always the best climate

Zehnder EVO 2 ventilation unit

Refer to the full installation and use manuals for additional information and instructions. To download them, scan the QR codes at the back of this quick guide.

Zehnder EVO 2 is a centralised mechanical ventilation unit with high-efficiency recovery unit (recovery of heat alone in HRV units, recovery of heat and humidity in ERV units) which expels stale air while simultaneously supplying fresh air to rooms.

It can be installed in homes, offices and similar locations.

Safety instructions - General notes

- Zehnder EVO 2 can only be used if it has been installed by a specialist engineer in accordance with current regulations and the instructions provided in the full installation manual.
- Do not open or modify the ventilation unit. Physical or software changes cause the loss of warranty cover and may lead to malfunctions or personal injury.
- Do not start up the ventilation unit when open: the electrical voltage and the movement of the fans may cause personal injury.

 **Unless otherwise required in this manual, keep the unit operating at all times. Otherwise, damp may build up and mould may form.**

 **WARNING! Hazardous electric voltage.**

- In the event of a natural disaster, disconnect the power supply.

 **Safety instructions - Installation**

- Always comply with general and local regulations with regard to building construction, safety and installation. Install a safety circuit breaker for disconnection of the power supply. Comply with the instructions provided in the installer manual.
- Connected to a 230 V - 50 Hz mains power supply; a circuit breaker should be installed.
- Install the unit in a location where the temperature and humidity are always within the range specified in the installation manual.
- Do not install in locations with saunas or swimming-pools, excessive humidity, excessive dust or harmful or potentially corrosive substances.
- Check that there is sufficient space for the air distribution system in the installation area. Leave the ventilation unit completely accessible to enable maintenance procedures.

Installation

 **Disconnect the power supply.**

Check the spaces available before starting installation.

The fittings for connection to the distribution system can be turned through 90°. Follow the instructions provided in the installation manual.

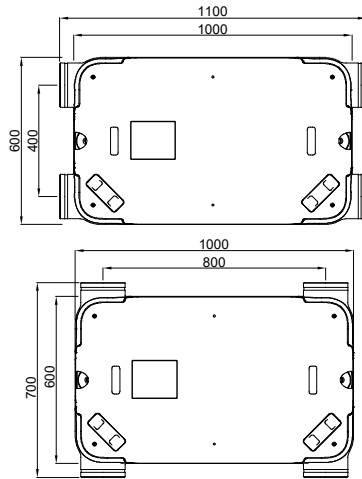

Handle the Zehnder EVO unit with care. Two people are always required to lift the unit. Do not lift the unit by the fittings as this may damage them.

Open the top of the cardboard packaging. Lift the ventilation unit and place it on a clean, soft surface. Use the cardboard box as template for drilling the holes required for installation.

The brackets supplied can be used on either the long or the short side of the unit. In the latter case, the supports already installed on the unit have to be moved to new positions. Refer to the installation manual.

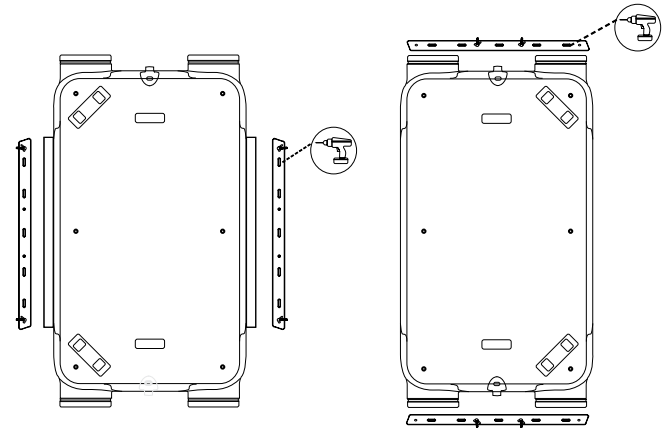

The unit can be ceiling-mounted in the default “factory version” or in “mirror version”, obtained by placing a jumper over connectors 9 and 10.

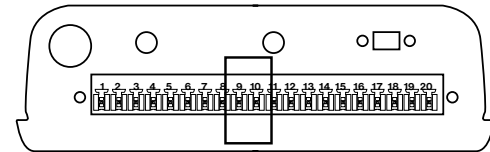

When ceiling-mounted, the unit must NOT be sloping; it must be levelled.

! This diagram **ONLY** applies for ceiling-mounting

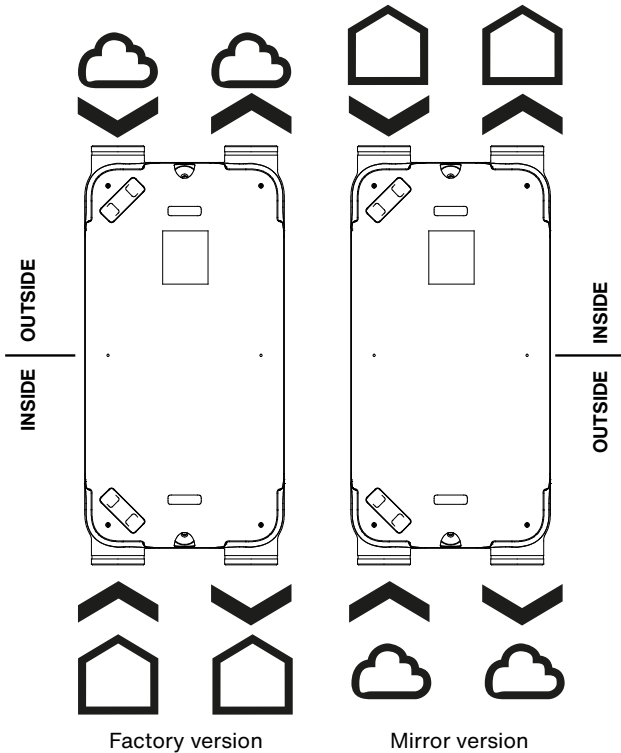

IMPORTANT!

Modification of the model from right-hand to left-hand "Mirror version" is **NOT** possible for models: EVO 2 HRV PR and EVO 2 ERV PR

! For wall-mounting, the following instructions **MUST** be complied with.

The unit must be installed vertically, and levelled on the vertical plane, to enable effective condensate drainage.
The unit must only be installed with the control board connector facing upward.

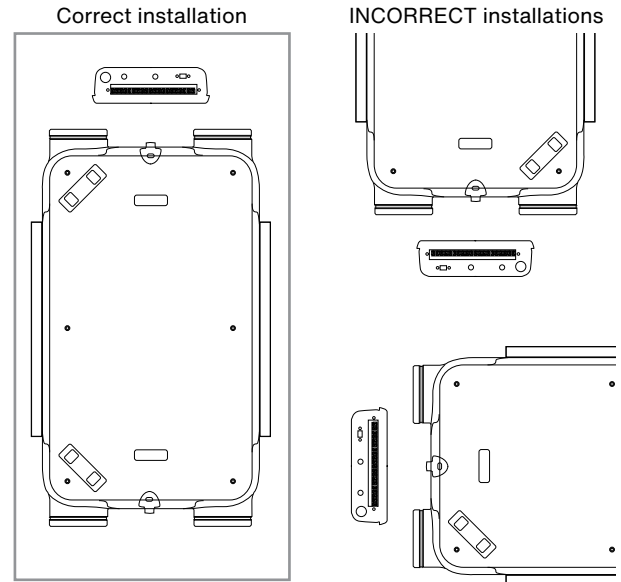

The HRV unit must **ONLY** be installed in “mirror version”, with the outside air inlet and stale air outlet connection point facing downward

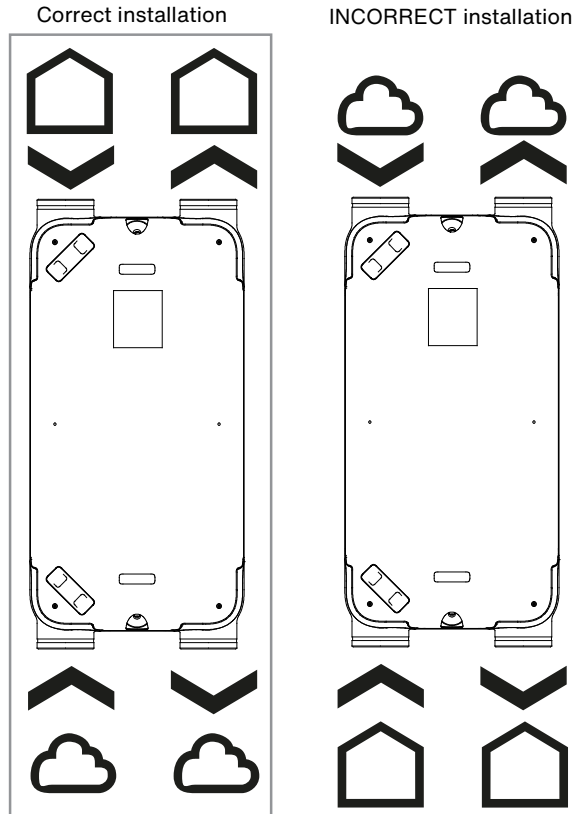

Installing the condensate drain

Zehnder EVO 2 HRV and Zehnder EVO 2 HRV PR units must be connected to a condensate drain system with unobstructed flow, protected from frost.

Screw the 1/2" male threaded siphon (not included in the supply package, must be ordered separately) onto the unit's condensate drain fitting. Install the siphon so that it can easily be removed during maintenance.

The unit's condensate drain connection may be pointing horizontally or downwards.

In the event of horizontal installation, the gradient of the condensate drain system must not be horizontal or towards the unit.

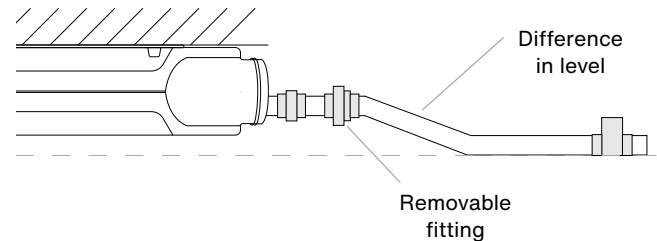

In EVO 2 HRV and EVO 2 HRV PR units only one condensate drain is connected; the other one must be plugged.
In EVO 2 ERV and EVO 2 ERV PR units both condensate drains must be plugged.
The plugs are supplied.

Schematic diagram

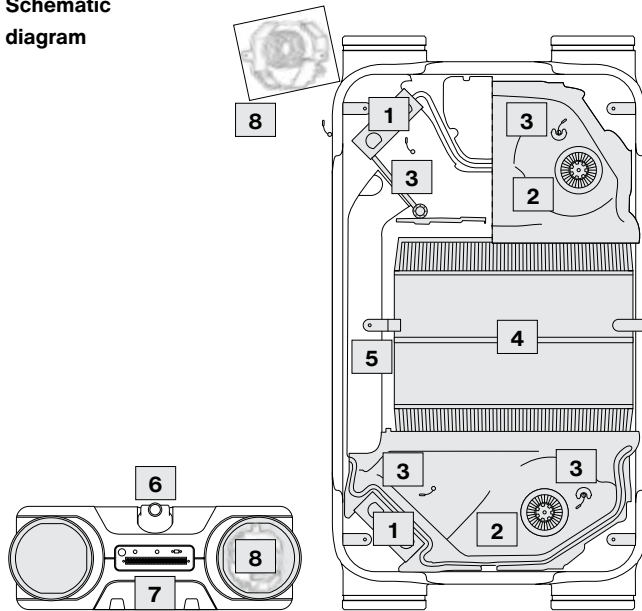

1	High-performance filters
2	Energy-saving fans
3	Temperature sensors
4	High-efficiency heat exchanger
5	Automatic bypass
6	Condensate drain
7	Electrical connections
8	Electric preheater (in HRV PR and ERV PR versions)

Control accessories

The unit is supplied WITHOUT control accessories. Refer to the user manual or installation manual for the accessories available.

The following is an overview of the electrical connections

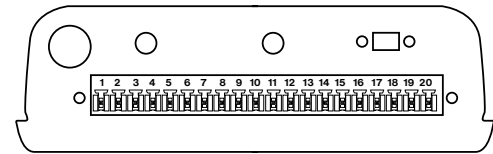

1	Home automation - 10 V	11	Not used
2	Home automation - 0 V	12	Selector switch V1 common
3	Home automation - volt free contact	13	Selector switch V2
4	Home automation - volt free contact	14	Selector switch V3
5	Not used	15	Preheater 230 V output (**)
6	Not used	16	Preheater ground output (**)
7	After-heater 10 V output (*)	17	Preheater neutral output (**)
8	After-heater 10 V output 0 V (*)	18	Not used
9	"Mirror mode" NO/NC (*)	19	Not used
10	"Mirror mode" NO/NC (*)	20	Not used

(*) Pin not used on models Zehnder EVO 2 HRV PR and Zehnder EVO 2 ERV PR

(**) In models with preheater included as standard, these pins are used for the after-heater (optional) and not for the preheater

Declaration of performance – Zehnder EVO 2 HRV / EVO 2 HRV PR

Release data: 15/11/2024

Product Datasheet According to Regulation (EU) NO.1254/2014 – ANNEX IV

Supplier's name or trade mark	Zehnder Group			Zehnder Group			Zehnder Group			Zehnder Group		
Supplier's model identifier	Zehnder EVO 2 HRV / EVO 2 HRV PR			Zehnder EVO 2 HRV / EVO 2 HRV PR			Zehnder EVO 2 HRV / EVO 2 HRV PR			Zehnder EVO 2 HRV / EVO 2 HRV PR		
SEC [kWh/(m ³ a)] specific energy consumption (cold, average, warm)	-74,2	-36,6	-12,5	-75,3	-37,6	-13,3	-77,5	-39,4	-14,9	-81,5	-42,5	-17,6
SEC class (cold, average, warm) climate	A+	A	E	A+	A	E	A+	A	E	A+	A+	E
Ventilation unit type	Two-way residential ventilation unit (RVU)											
Drive type installed	Multi-speed control			Multi-speed control			Variable speed control			Variable speed control		
Type of heat recovery system	Static heat recovery			Static heat recovery			Static heat recovery			Static heat recovery		
Thermal efficiency [%]	87			87			87			87		
Maximum flow rate [m ³ /h]	200			200			200			200		
Maximum electrical power input [W]	78,3			78,3			78,3			78,3		
Sound power level (LWA) [dB(A)]	49			49			49			49		
Reference flow [m ³ /h]	141			141			141			141		
Reference pressure difference [Pa]	50			50			50			50		
Specific fan power (specific power input - SPI -) [W/(m ³ /h)]	0,248			0,248			0,248			0,248		
Control factor and type installed or intended to be installed	"1 Manual control"			"0,95 Timer"			"0,85 Centralised climate control"			"0,65 Local demand control"		
Maximum declared internal and external leak rate [%]	Internal: 2 External: 2,6			Internal: 2 External: 2,6			Internal: 2 External: 2,6			Internal: 2 External: 2,6		
Visual filter warning position and description	Warning on unit display or room controller			Warning on unit display or room controller			Warning on unit display or room controller			Warning on unit display or room controller		
Website for technical documentation	www.zehnder.it			www.zehnder.it			www.zehnder.it			www.zehnder.it		
Annual electricity consumption by climate (cold, average, warm) per surface area of 100 m ² (AEC) [kWh/a]	893	356	311	863	326	281	807	270	225	713	176	131
Annual heating savings in a (cold, average, warm) climate for an apartment with a surface area of 100 m ² (AHS) [kWh/a]	8776	4486	2029	8817	4507	2038	8898	4548	2057	9060	4631	2094

Important notice

Ensure there are air filters to keep the recovery unit's energy efficiency high, and regularly carry out cleaning and replacement maintenance. Read the instructions in the use and maintenance manual.

Warning

Always ensure a filter is used. To prevent reduced effectiveness of your energy recovery ventilation, be sure to clean dirt and dust from the filter and heat exchange element at regular intervals. See the operating instructions manual.

Declaration of performance – Zehnder EVO 2 ERV / EVO 2 ERV PR

Release data: 15/11/2024

Product Datasheet According to Regulation (EU) NO.1254/2014 – ANNEX IV

Supplier's name or trade mark	Zehnder Group			Zehnder Group			Zehnder Group			Zehnder Group		
Supplier's model identifier	Zehnder EVO 2 ERV / EVO 2 ERV PR			Zehnder EVO 2 ERV / EVO 2 ERV PR			Zehnder EVO 2 ERV / EVO 2 ERV PR			Zehnder EVO 2 ERV / EVO 2 ERV PR		
SEC [kWh/(m ³ a)] specific energy consumption (cold, average, warm)	-69,4	-34,3	-11,5	-70,8	-35,4	-12,4	-73,5	-37,4	-14,1	-78,3	-41,0	-17,0
SEC class (cold, average, warm) climate	A+	A	E	A+	A	E	A+	A	E	A+	A	E
Ventilation unit type	Two-way residential ventilation unit (RVU)											
Drive type installed	Multi-speed control			Multi-speed control			Variable speed control			Variable speed control		
Type of heat recovery system	Static heat recovery			Static heat recovery			Static heat recovery			Static heat recovery		
Thermal efficiency [%]	79			79			79			79		
Maximum flow rate [m ³ /h]	201			201			201			201		
Maximum electrical power input [W]	80,5			80,5			80,5			80,5		
Sound power level (LWA) [dB(A)]	49			49			49			49		
Reference flow [m ³ /h]	141			141			141			141		
Reference pressure difference [Pa]	50			50			50			50		
Specific fan power (specific power input - SPI -) [W/(m ³ /h)]	0,241			0,241			0,241			0,241		
Control factor and type installed or intended to be installed	"1 Manual control"			"0,95 Timer"			"0,85 Centralised climate control"			"0,65 Local demand control"		
Maximum declared internal and external leak rate [%]	Internal: 2 External: 2,6			Internal: 2 External: 2,6			Internal: 2 External: 2,6			Internal: 2 External: 2,6		
Visual filter warning position and description	Warning on unit display or room controller			Warning on unit display or room controller			Warning on unit display or room controller			Warning on unit display or room controller		
Website for technical documentation	www.zehnder.it			www.zehnder.it			www.zehnder.it			www.zehnder.it		
Annual electricity consumption by climate (cold, average, warm) per surface area of 100 m ² (AEC) [kWh/a]	884	347	302	855	318	273	800	263	218	710	173	128
Annual heating savings in a (cold, average, warm) climate for an apartment with a surface area of 100 m ² (AHS) [kWh/a]	8278	4232	1913	8343	4265	1929	8474	4332	1959	8736	4466	2019

Important notice

Ensure there are air filters to keep the recovery unit's energy efficiency high, and regularly carry out cleaning and replacement maintenance. Read the instructions in the use and maintenance manual.

Warning

Always ensure a filter is used. To prevent reduced effectiveness of your energy recovery ventilation, be sure to clean dirt and dust from the filter and heat exchange element at regular intervals. See the operating instructions manual.

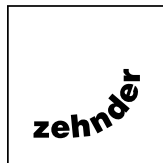

Scan to get
USER
manual!

A black rounded rectangular button containing a white QR code on the left and the text "Scan to get USER manual!" on the right.

Scan to get
INSTALLER
manual!

A black rounded rectangular button containing a white QR code on the left and the text "Scan to get INSTALLER manual!" on the right.