

# CERTIFICATE

Certified Passive House Component

Component-ID 1605sr00 valid until 31st December 2022

Passive House Institute  
Dr. Wolfgang Feist  
64283 Darmstadt  
Germany

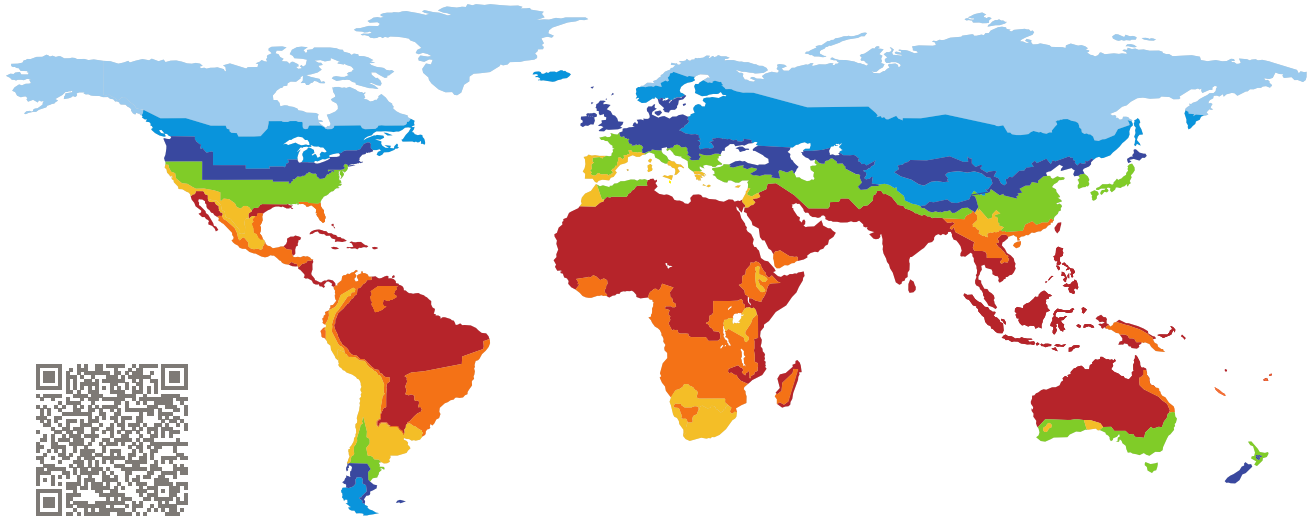

Category: **Drain water heat recovery**  
Manufacturer: **ZYPHO,  
Vila Nova de Gaia,  
Portugal**  
Product name: **ZYPHO iZi 40**

## This certificate was awarded based on the following criteria:

Tested under standard boundary conditions<sup>1</sup> the system reduces the useful energy demand for shower by

30%  $\geq$  30%

## Further properties

Pressure drop tap water at 8 l/min: 0.27 bar  
Connection tap water: 1/2" AG  
Connection waste water: DN 50

nominal efficiency
37%
effective dead time
5 s
design flow rate
8 l/min

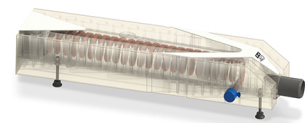

<sup>1</sup>Balanced flow rates, cold water temperature 10 °C, Temperature at shower head 40 °C, waste water temperature 35 °C, negligible pipe length, shower time 6 min, flow rate 8 l/min

Passive House  
efficiency class

phE

phD

phC

phB

phA

phA+

all climate zones



**CERTIFIED  
COMPONENT**

Passive House Institute